

SK1-15-30/4-NBO-VA/PTFE

CS003F

### Wiring Diagram

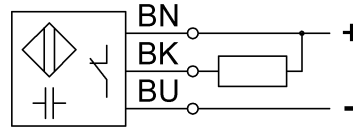
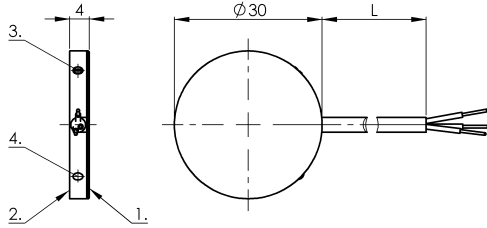

1) Sensing surface 2) Housing 3) Potentiometer 4) LED function indicator



### Electrical connection

Cable length	2 m
Conductor cross-section	0.14 mm <sup>2</sup>
Connection type	Cable, 2.00 m, PUR
Number of conductors	3
Polarity reversal protected	yes
Short-circuit protection	yes

### Electrical data

Hysteresis H max. (% of Sr)	15.0 %
MTTF (40 °C)	230 a
Operating voltage U <sub>b</sub>	10...35 VDC
Protected against miswiring	yes
Rated insulation voltage U <sub>i</sub>	75 V DC
Rated operating current I <sub>e</sub> DC	300 mA
Repeat accuracy max. (% of Sr)	2.0 %
Switching frequency	100 Hz
Utilization category	DC -13
Voltage drop static max.	0.8 V

### Environmental conditions

Ambient temperature	-30...70 °C
Protection type IEC 60529	IP67

### Functional safety

Diagnostic coverage	0 %
Functional safety	no

### General data

Approval/Conformity	CE cULus
Basic standard	IEC 60947-5-2
Sensitivity	Switching distance adjustable

### Material

Housing material	Stainless steel (1.4301)
Material jacket	PUR
Material sensing surface	PTFE

### Mechanical data

Dimension	Ø 30 x 4 mm
Installation	for flush mounting
Size	D30.0

### Output/Interface

Switching output	NPN Normally closed (NC)
------------------	--------------------------

### Range/Distance

Measuring range	2...15 mm
Range	2...15 mm
Rated operating distance S <sub>n</sub>	15 mm
Ripple max. (% of U <sub>e</sub> )	10 %
Temperature drift max. (% of Sr)	20 % [-5...55 °C]

For further information on MTTF/B10d, please refer to the MTTF / B10d Certificate.

Specification of the MTTF value and the B10d value do not represent any binding quality and/or life expectancy guarantees.