

SK1-TM-6-M12/63-PNBO-CPTFE

Ordercode: CS009K

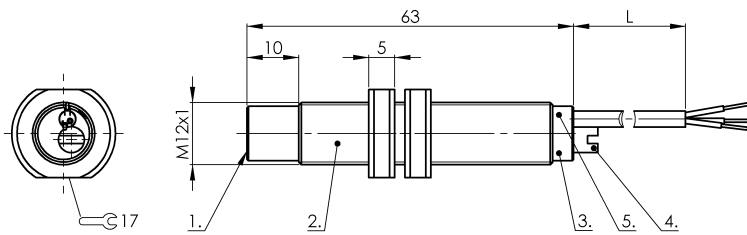

Wiring Diagram

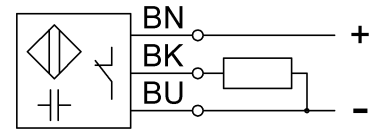

1) Sensing surface 2) Housing 3) Cover 4) Potentiometer 5) LED function indicator



### Electrical connection

Cable length	2 m
Conductor cross-section	0.20 mm <sup>2</sup>
Connection type	Cable, 2.00 m, PTFE
Number of conductors	3
Polarity reversal protected	yes
Short-circuit protection	yes

### Electrical data

Hysteresis H max. (% of Sr)	15.0 %
Operating voltage Ub	12...35 VDC
Protected against miswiring	yes
Rated insulation voltage Ui	75 V DC
Rated operating current Ie DC	200 mA
Repeat accuracy max. (% of Sr)	2.0 %
Switching frequency	25 Hz
Utilization category	DC-13
Voltage drop static max.	0.8 V

### Environmental conditions

Ambient temperature	-30...60 °C
Protection type IEC 60529	IP65

### General data

Approval/Conformity	CE cULus
---------------------	-------------

Basic standard  
Scope of delivery  
Sensitivity

IEC 60947-5-2  
Nut (2x)  
Switching distance adjustable

### Material

Cover material	PTFE
Housing material	PTFE
Material cover	PTFE
Material jacket	PTFE
Material sensing surface	PTFE

### Mechanical data

Dimension	undefined
Installation	non-flush
Size	M12x1
Tightening torque	0.5 Nm

### Output/Interface

Switching output	PNP Normally closed (NC)
------------------	--------------------------

### Range/Distance

Measuring range	1...6 mm
Range	1...6 mm
Rated operating distance Sn	6 mm
Ripple max. (% of Ue)	10 %
Temperature drift max. (% of Sr)	15 %